

SECONDARY PACKAGING

FAST PICKER CELL

for assembling and packaging of products
at high flexibility (e.g. VARIETY)



The CM-OPM FAST PICKER CELL consists of several CM-OPM FAST PICKER ROBOTS that pick up products which arrive randomly on a conveyor belt, placing them on different outputs (depending on applications), at a speed of up to 150 cycles per minute.

Thanks to their integrated vision system, the CM-OPM FAST PICKER ROBOTS are able to recognize the positioning and orientation of incoming products. Each robot consists of three arms for picking head displacement in X-Y-Z directions and one axis wrist with single rotation for high speed picking.

Depending on the solution, the CM-OPM Fast Picker Robots can release the product directly onto a CMOPM flow wrapper (creating the final configuration ready to be flow wrapped) or onto wrapping machines infeed, or can place products on trays, inside boxes and cases or can set up layers for case packers.

STANDARD FEATURES

FAST PICKER CELL features

- High modularity
- Common frame for all machine modules in electro-welded painted structure with floor levelling feet
- Safety guard door system in transparent polycarbonate, located on the external perimeter of the Cell

FAST PICKER ROBOT features

- Integrated power electronics system
- High resolution visual system
- Lightweight design with simple aluminum profile frames
- Controlled by a Motion Controller

LAYOUT FAST PICKER CELL for a CMOPM FLOW-WRAPPING INFEED

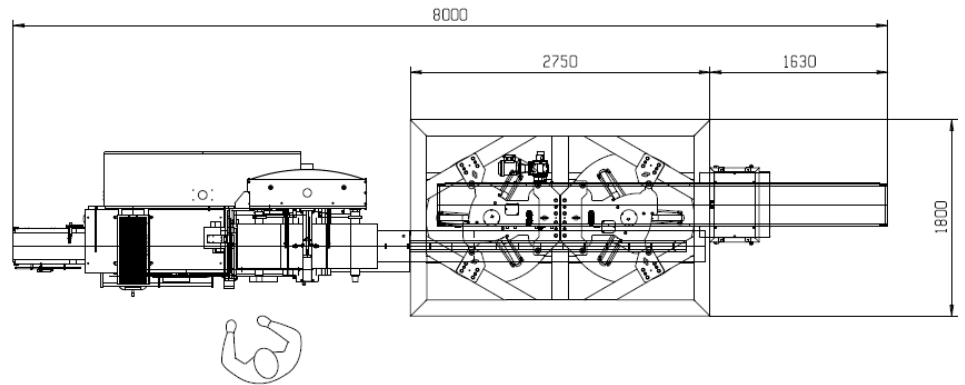
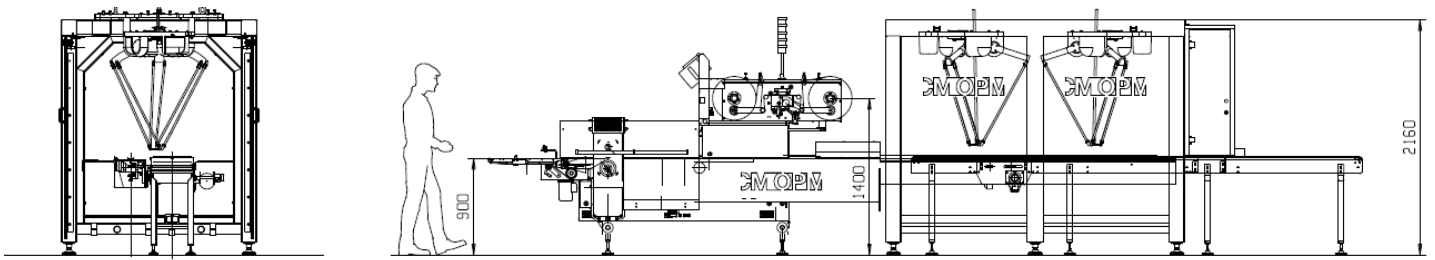

TECHNICAL DATA FAST PICKER ROBOT

Robot version	8	12
Number of axes	4 (opt 3)	4 (opt 3)
Work range (cylinder)	Ø800 × 210 mm	Ø1200 × 250 mm
Payload	1 kg	3 kg
Rotational torque	1 Nm	1Nm
Cycle Time (without handling)		
25/305/25 - 0.1 kg	0.35 s	0.36 s
25/305/25 - 1.0 kg	0.48 s	0.46 s
40/700/40 - 0.1 kg	0.52 s	0.52 s
40/700/40 - 1.0 kg	0.72 s	0.59 s
Position Repeatability	±0.15 mm	±0.15 mm
Angular Repeatability	±0.5 °	±0.5 °

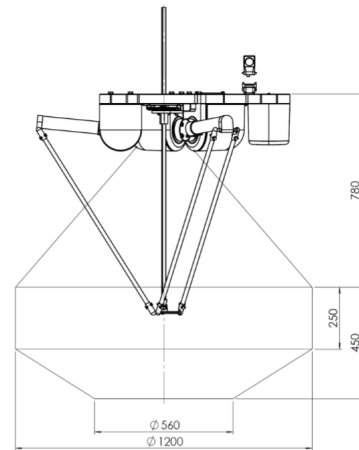

12 version LAYOUT

