

# SECONDARY PACKAGING

## CE-HMC Case Erectors



**American style (RSC) case erector for pre-glued blanks:**

- Hot melt gluing
- Compact design
- Easy production changeover
- On board electrical panel
- Hygienic design
- Quick changeover

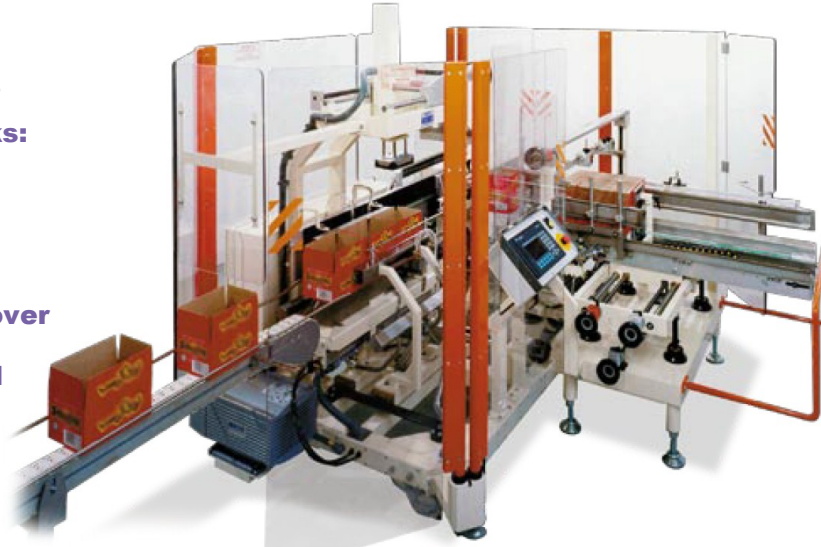

**STANDARD FEATURES**

- Electro-welded painted frame, with floor levelling feet
- Openable safety guards made of transparent polycarbonate
- Carton magazine with side loading features, pneumatic infeed indexer with controlled pressure, 1.100 mm long, adjustable in width and height by handwheels with gauges indicator
- Carton extracting arm from the magazine, installed on a mobile trolley that erects the cartons and folds front and back flaps by “positive” motion
- Electro-pneumatic system to seal the four lower flaps, complete with Automatic Hot Melt Glue Dispenser including two guns and two glue distribution hoses
- On-board electrical cabinet equipped with Siemens or Allen Bradley PLC
- MMI touch panel interface for recipe selection, fault display and parameter editing
- Speed: up to 18 cases per minute, depending on case size and cardboard quality

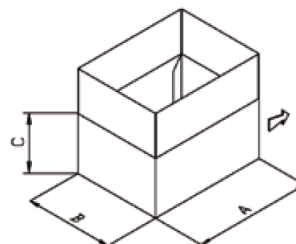
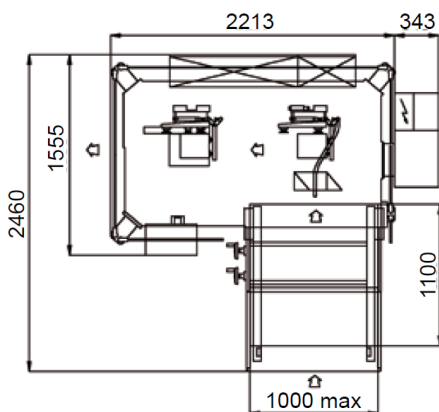

	A	B	C
Min.	200	150	125
Max.	600	400	400

# SECONDARY PACKAGING

## CE-E Case Erectors

Servo-driven american style (RSC) case erector for pre-glued blanks:

- Hot melt gluing
- Compact design
- Easy production changeover
- On board electrical panel
- Hygienic design
- Quick changeover

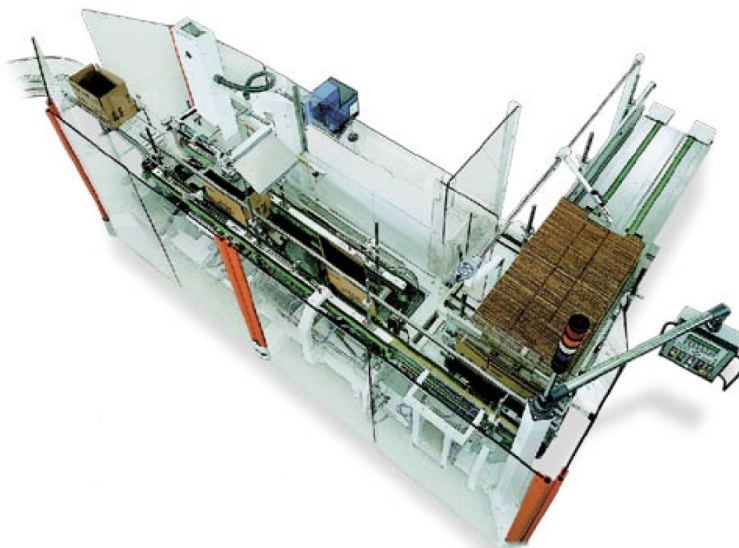

STANDARD FEATURES

- Electro-welded painted frame, with floor levelling feet
- Openable safety guards made of transparent polycarbonate
- Carton magazine with side loading features, pneumatic infeed indexer with controlled pressure, 1.600 mm long, adjustable in width and height by hand-wheels with gauges indicator (an extended magazine version of 3000 mm is available)
- Positive, high-efficient and servo-driven carton unfolding mechanism
- Electro-pneumatic system to seal the four lower flaps, complete with Automatic Hot Melt Glue Dispenser including two guns and two glue distribution hoses
- On-board electrical cabinet equipped with Siemens or Allen Bradley PLC
- MMI touch panel interface for recipe selection, fault display and parameter editing
- Speed: up to 20 cases per minute, depending on case size and cardboard quality
- Right and left version available

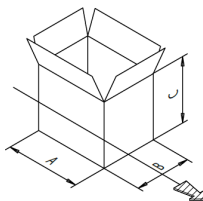
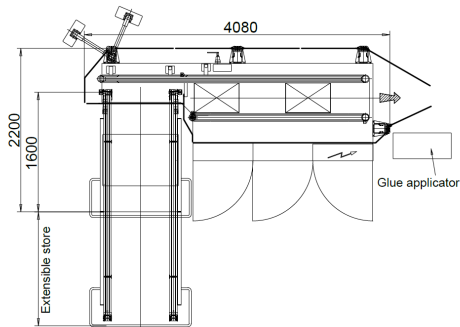

	A	B	C
Min.	200	200	150
Max.	600	400	400